

ZN-T5/W

Body Temperature Detection Network Camera



- On-board temp-detection algorithm
- One IP address two channels
- Effective pixels 400×300
- Sensitivity $\leq 40\text{mK}$
- Thermal: 8mm Fixed lens, Visible: 2.7~12mm motorized lens
- Accuracy $\pm 0.3^{\circ}\text{C}$
- Body temperature measurement up to 30 Targets
- Response Time $\leq 30\text{ms}$
- 17 color control

Specification

Thermal Camera		Visible Lens	
Detector Type	Uncooled IRFPA Microbolometer	Image Sensor	1/2.8" Sony CMOS
Effective Pixels	400(H) * 300(V)	Effective Resolution	1920(H) * 1080(V)
Pixel Size	17um	Shutter Speed	1/50 ~ 1/20,000s
Thermal Sensitivity (NETD)	$\leq 40\text{mK}$ @F1.0, 300K	Wide Dynamic Range	True WDR 120dB
Spectral Range	8 ~ 14um	Min. Illumination	Color: 0.1Lux @(F1.2, AGC ON) B/W: 0.01Lux @(F1.2, AGC ON)
Image Setting	Polarity LUT / DVE / Mirror / FCC / 3D DNR Brightness / Contrast / ROI	S / N Ratio	More than 55dB
Color Mode	Black-Heat / White-Heat / Rainbow / Iron-Red up to 17 modes	Focal Length	2.7 ~ 12mm
Thermal Lens		Max Aperture	F1.6 ~ F2.9
Lens Type	Fixed	FOV	105° ~ 32°
Focus Control	Manual Focus	Focus Control	Motorized
Focal Length	8mm		
Iris	F1.0		
FOV	H: 46°, V: 35°		

Video and Audio	
Compression	H.265, H.264, MJPEG
Frame Rate	Main Stream: Thermal: D1 @25 / 30fps Visible: 1920 * 1080 / 1280 * 720 @25 / 30fps Sub Stream: Thermal: CIF @25 / 30fps Visible: D1 / VGA / 640 * 360 / CIF / QCIF / QVGA @25 / 30fps
Bit Rate Control	CBR / VBR
Bit Rate	Thermal: 100Kbps ~ 6Mbps Visible: Main stream: 100Kbps~12Mbps Sub stream: 10Kbps ~ 1.5Mbps
Region of Interest	Off / On (8 Zone, Rectangle)
Digital Zoom	16x
Mirror	Support
Defog	Support
Motion Detection	Support
Privacy Masking	Off / On (4 areas, rectangle)
DVE Image Enhance	Support
Audio Compression	G.711, RAW_PCM
Intelligence	
Alarm	Motion detection, Disk alarm, I/O alarm, Temperature alarm
IVS	Smart Body Detection, Perimeter, Single Virtual Fences, Double Virtual Fences, Object Left, Object Removed
Temperature Detection	
Detection Mode	Body temperature monitoring
Detection Preset	Max 30 goals
Temperature Alarm	Over temperature alarm, temperature difference alarm
Accuracy	≤0.3°C (Emission rate, distance, ambient temperature) with blackbody
Response Time	≤30ms
Detection Range	-20°C ~ 60°C (-4°F ~ 140°F)
Temperature display mode	If temperature target >5°C, display absolute temperature value; If temperature target ≤5°C, display relative temperature value (temperature difference DEV = highest value - average)
Network	
Ethernet	RJ-45 (10 / 100Base-T)
Protocols	IPv4 / IPv6, HTTP, RTSP / RTP / RTCP, TCP / UDP, DHCP, DNS, PPPOE, SMTP, SIP, 802.1x
Interoperability	ONVIF, CGI, SDK
Streaming Method	Unicast
Max. User Access	10 Users
Edge Storage	NAS Local PC for instant recording Micro SD card 128GB
Web Viewer	<IE11, Chrome, Firefox
Web Language	English, Chinese, Polish, Italian, Portuguese, Spanish, Russian, French, Czech, Hungarian
Interface	
Ethernet	1 Ethernet (10 / 100 Base-T) RJ-45 Connector
Audio	1ch Audio In, 1ch Audio Out
Alarm	2ch Alarm In, 2ch Alarm Out
RS485	Support
BNC Output	N / A
Reset Button	Support (Built-in)
General	
Power Supply	DC12V / POE (IEEE 802.3af)
Power Consumption	Max 10W
Operating Temperature	-30°C ~ 60°C (-22°F ~ 140°F)
Storage Conditions	0 ~ 90% RH
Certifications	CE / FCC
Ingress Protection	IP66
Casing	Metal
Dimensions	212 * 182 * 136 (mm)
Net Weight	2.1kg

Dimensions (mm)

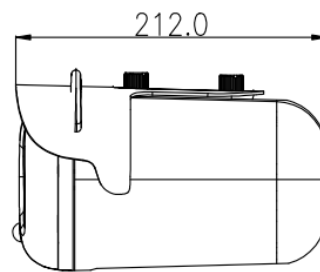
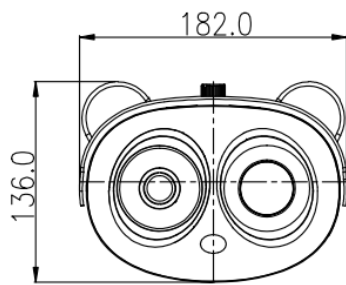

Accessories

Optional:



ZN - BK01
Wall bracket



ZN - BK02
Ceiling Bracket